

## Safety Precautions

Prior to utilizing the product, it is essential to thoroughly review this user manual and retain it in a secure location for subsequent reference.

### ⚠ Danger

Please do not allow this product to contact water directly. Be cautious to use the stand in damp conditions or inclement weather.



### ⚠ Warnings

- To prevent the bracket from tilting or incurring damage, it is imperative to avoid its placement in unstable locations.
- Covering the bracket with materials such as cloth or paper should be avoided, as this poses a risk of fire.
- Forceful bending or pulling of the power cord is discouraged, as compromised cords could lead to fire or electric shock incidents.
- Arbitrary modifications or replacement of the bracket's components are not recommended, as these actions could lead to electric shock, fire, or other unintended consequences.
- The insertion of metal objects or flammable materials into the bracket's crevices is strongly advised against to prevent risks of fire or electric shock.
- It is advisable to avoid situating the bracket near flammable materials that could be affected by wind, thereby mitigating fire hazards.
- Ensuring the bracket is positioned on a level surface is crucial to avoid its tilting or potential damage.
- In the event of damage to the bracket's external cable or cord, replacement should be conducted by the manufacturer or a qualified technician to circumvent hazards.
- Should any irregularities be observed, immediate disconnection of the power supply is recommended for a thorough inspection, and contacting the dealer for assistance is advised.

### ⚠ Cautions

- Prior to utilization, it is crucial to remove all packaging attachments from the product.
- Ensure that the bracket is devoid of any packaging attachments and adhesives before operation to mitigate the risk of fire hazards.
- This bracket features a basic waterproof design; however, improper usage may compromise insulation and lead to electric shock.
- To avert fire risks, maintain a safe distance between the lamp and any flammable materials.
- Avoid disconnecting the power cord with damp hands to prevent the occurrence of electric shock incidents.
- In instances where the bracket will not be in use for an extended period, it is advisable to disconnect the control device from the electrical socket to prevent potential fire hazards.



meKing®

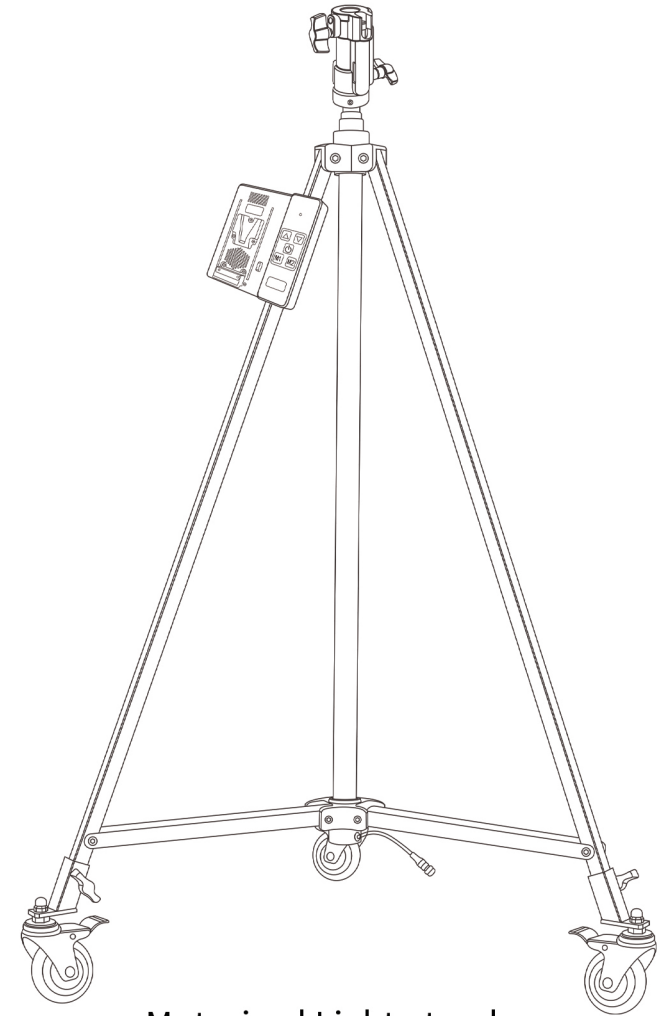

Motorized Light-stand

## The Seeker: DK-4030F

Meking Professional Light Stand  
User Manual

Manufacturer: Yuyao Meking Film and Television  
Equipment Co., Ltd.

Service Hotline: 0574-62198060

Brand Official Website: [www.mekingphoto.com](http://www.mekingphoto.com)

## Product Introduction

Thank you for choosing Meking! The DK-4030F wireless electric stand features an all-aluminum construction with a "V-mount" battery system, enabling cordless height adjustment.

## Product Description

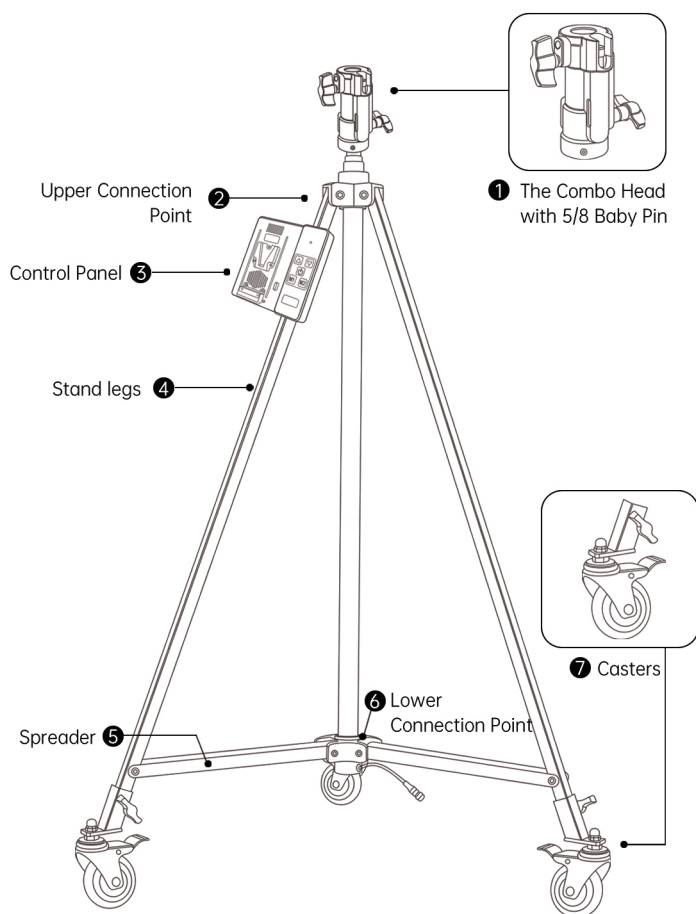

## Product Specifications

Minimum height	1565mm	Diameter	28 35 40
Maximum height	2910mm	Tripod legs	25*25
Collapsed height	1580mm	Load capacity	15kg
Net weight	15.05KG	Footprint	1020mm
Sections	3	Packaging	1PCS

## Applications

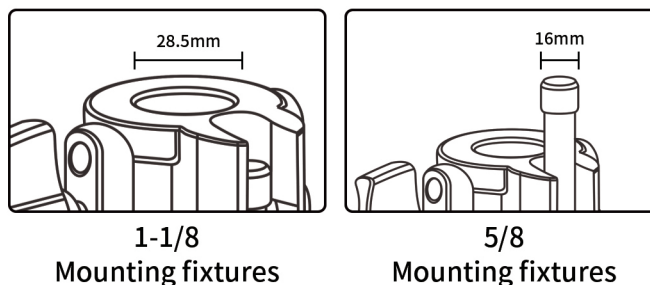

### ⚠ Cautions

- The bracket should never remain connected to the power supply when not in use.
- It is imperative to turn off the power and disconnect the bracket after each usage.
- While this product is designed to be waterproof, it is not advisable to use it outdoors under conditions of extreme moisture or rain for extended durations.
- Adherence to the following steps is essential for proper use.

- ① Insert the "V-mount" battery, connect the power adapter, controller and light stand cables. Compatible battery voltage: 12-16.8V.
- ② Initial reset: Simultaneously press and hold the up and down buttons for approximately 5 seconds to activate the stand reset. This only needs to be performed once during initial setup. After power cycling, the green indicator light confirms normal operation.
- ③ Dynamic demo: Simultaneously press and hold the stop and M1 buttons for approximately 5 seconds to activate the demonstration function.

- ④ Memory height setting M1/M2: When reaching the desired height, press and hold the M1 button for approximately 5 seconds until the indicator light flashes to confirm the height setting. After height adjustment, press M1 once to return to the preset height.
- ⑤ After use: Remove the "V-mount" battery.

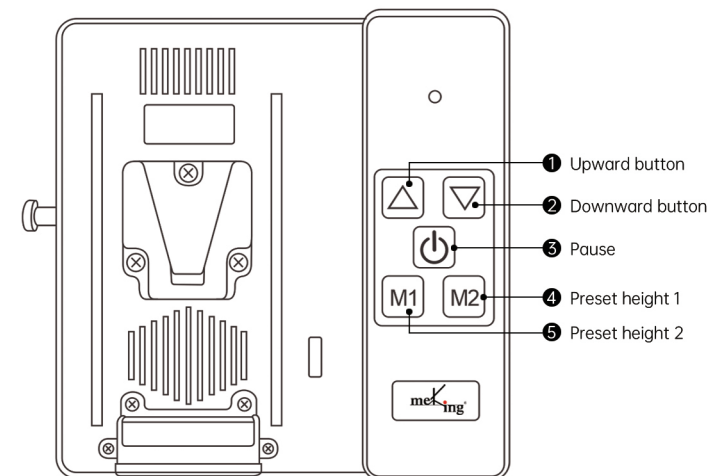

## Fault Resolution

If there is an issue with the product and it cannot be resolved using the following information, please contact Meking store customer service or the service hotline.

### Should the product be non-operational:

The battery may be depleted or have poor contact. Please check the battery level. If the battery is nearly drained, replace it with a fully charged one; if the contact is poor, clean the battery terminals to ensure proper connection.

Examine the product's power cord for any damage. In the event of damage to the power cord, it is imperative that it be replaced by personnel specialized from Meking to eliminate any potential risks.